

DIN 卡套式管接头

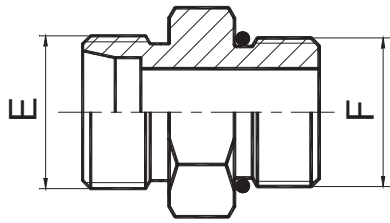

1CO
1DO

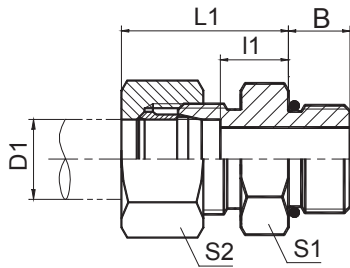

1CO-RN
1DO-RN

美制螺纹O形圈密封柱端
UN、UNF THREAD STUD ENDS
WITH O-RING SEALING

代号 PART NO.	螺纹 THREAD		管子外径 TUBE O.D.		尺寸 DIMENSIONS					压力等级 MPa
	E	F	D1		B	l1	L1	S1	S2	
1CO-14-04	M14X1.5	7/16"X20	8		9	10	25	17	17	31.5 轻系列 L
1CO-16-04	M16X1.5	7/16"X20	10		9	11	26	17	19	
1CO-18-06	M18X1.5	9/16"X18	12		10	11	26	19	22	
1CO-18-08	M18X1.5	3/4"X16	12		11	13	28	24	22	
1CO-18-10	M18X1.5	7/8"X14	12		12.7	14.3	29	27	22	
1CO-22-08	M22X1.5	3/4"X16	15		11	14	29	24	27	
1CO-22-10	M22X1.5	7/8"X14	15		12.7	15.3	30	27	27	
1CO-22-12	M22X1.5	1.1/16"X12	15		15.09	11.91	30	32	27	
1CO-26-08	M26X1.5	3/4"X16	18		11	14.5	31	27	32	
1CO-26-10	M26X1.5	7/8"X14	18		12.7	14.8	31	27	32	
1CO-30-08	M30X2	3/4"X16	18		11.13	13.87	33	32	36	
1CO-30-10	M30X2	7/8"X14	22		12.7	16.8	33	32	36	
1CO-30-12	M30X2	1.1/16"X12	22		15	16.5	33	32	36	
1CO-30-16	M30X2	1.5/16"X12	22		15	17.5	34	41	36	
1CO-36-12	M36X2	1.1/16"X12	28		15.09	14.41	34	41	41	
1CO-36-16	M36X2	1.5/16"X12	28		15	17.5	34	41	41	
1CO-45-16	M45X2	1.5/16"X12	35		15	17.5	39	46	50	
1CO-45-20	M45X2	1.5/8"X12	35		15.09	16.41	39	50	50	
1CO-52-20	M52X2	1.5/8"X12	42		15.09	15.91	42	55	60	
1DO-16-04	M16X1.5	7/16"X20	8		9	15	30	17	19	63 重系列 S
1DO-18-06	M18X1.5	9/16"X18	10		10	14.5	31	19	22	
1DO-20-06	M20X1.5	9/16"X18	12		10	14.5	31	22	24	
1DO-20-08	M20X1.5	3/4"X16	12		11	17.5	34	24	24	40 重系列 S
1DO-24-08	M24X1.5	3/4"X16	16		11	15.5	34	24	30	
1DO-24-10	M24X1.5	7/8"X14	16		12.7	18.8	37	27	30	
1DO-30-08	M30X2	3/4"X16	20		11	20.5	42	32	36	
1DO-30-10	M30X2	7/8"X14	20		12.7	20.8	42	32	36	
1DO-30-12	M30X2	1.1/16"X12	20		15	20.5	42	32	36	
1DO-36-12	M36X2	1.1/16"X12	25		15.09	19.91	47	41	46	
1DO-36-16	M36X2	1.5/16"X12	25		15	23	47	41	46	
1DO-42-16	M42X2	1.5/16"X12	30		15	23.5	50	46	50	
1DO-42-20	M42X2	1.5/8"X12	30		15	23.5	50	50	50	
1DO-52-20	M52X2	1.5/8"X12	38		15.09	22.9	53.9	55	60	31.5重系列S

注：如需带卡套及卡套螺母整套订货，则请在代号后加“RN”，如1C9-30RN。

Note: In case if you are interested to order the adapter in complete set with cutting ring and nut ,it is necessary to insert suffix "RN" after our part no., for example 1C9-30RN.